

rapid test kits .

speed • specific • solution



**Proven shrimp diseases detection kits
is now within reach**

rapid test kits - WSSV . IMNV . YHV . MBV -

**SPEEDY
ASSAY**

www.speedyassay.com

ShrimpCheck Rapid Test Kit

Is Your Shrimp SAFE?

Despite the explosive growth in world production of cultivated shrimp, there have been periodic losses due to shrimp diseases and pandemic viruses such as WSSV, YHV, MBV and IMNV. These four major infectious viruses, WSSV, IMNV, MBV and YHV are among the most serious pandemic viruses that have adversely affected the economy losses in global penaeid shrimp farming industry.

Disease Preventive Management

To mitigate the risk of economic losses due to outbreak, a reliable and rapid preventive management tool for early detection of infectious diseases has become vital in shrimp farm management.



Why Choosing ShrimpCheck Rapid Test Kit?

- **Rapid**
Immediate results obtained within 20 minutes
- **Simple to use**
Easy procedures, does not require technical specialist
- **On-site pre-screening**
Convenient and quick on-the-field detection, save your time
- **No expensive tools**
Does not require expensive equipment or tools
- **Cost effective**
More tests can be performed simultaneously and more representative data

Introducing ShrimpCheck Rapid Test Kits

We are proud to introduce the second generation immunochromatographic assays designed for qualitative detection of viral infection in shrimp. It is one of the most cost effective shrimp disease rapid test kit products available in the market. ShrimpCheck Rapid Test Kits are sensitive and early enough to detect a relatively low level infection, prior to gross anatomical evidence of disease to achieve the goals of a basic shrimp aquaculture monitoring program. This easy-to-use screening tool is a practical and self-check approach which should be made mandatory or alternative for the relevant authorities.

On-site Detection, Fast & Easy

We have developed easy, convenient and rapid detection kits for qualitative detection of four major diseases (WSSV, YHV, MBV and IMNV). The results can be read visually without any expensive instruments. The farmers can use the kits by the pond anytime thanks to the simplified and easy procedures, thus preventing your shrimps from the highly infectious diseases.

Alternative to Lab Test

Monitoring a shrimp population through a PCR based approach would significantly increase the operation cost of any shrimp farm. It is crucial that shrimp diseases rapid test kits are being introduced and fully applied in the shrimp farms to minimize the damage & losses caused by the major shrimp pandemic diseases worldwide. Our rapid test kits are cost effective immunochromatographic detection system, offering a potential alternative to more complex and costly PCR assay.

White Spot Syndrome Virus (WSSV) Rapid Test Kit

White spot syndrome virus (WSSV) is a highly infectious viral pathogen that causes mass mortality in farmed penaeid shrimps worldwide. WSSV has been known as the most prevalent, widespread and lethal to most of the commercially cultivated penaeid shrimp species.

Product description:

ShrimpCheck White Spot Syndrome Virus (WSSV) Rapid Test Kit is a management tool based on immunochromatographic assay designed for the qualitative detection of WSSV infection in shrimp.

Kit components:

- | | |
|---|--|
| 1. WSSV rapid test cassette (20 pcs) | 2. Buffer (1 dropper bottle) |
| 3. Microcentrifuge tube (20 pcs, single use only) | 4. Disposable pestle (20 pcs, single use only) |
| 5. Disposable dropper (20 pcs, single use only) | 6. Instruction manual |

Yellow Head Virus (YHV) Rapid Test Kit

Yellow Head Disease (YHD) is caused by infection of yellow head virus (YHV) on shrimp. YHV is a positive-sense single stranded RNA virus related to coronaviruses and arteriviruses. YHD outbreaks have been reported in black tiger prawn (*P. monodon*) and Whiteleg shrimp (*P. vannamei*).

Product description:

ShrimpCheck Yellow Head Virus (YHV) Rapid Test Kit is a management tool based on immunochromatographic assay designed for the qualitative detection of YHV infection in shrimp.

Kit components:

- | | |
|---|--|
| 1. YHV rapid test cassette (20 pcs) | 2. Buffer (1 dropper bottle) |
| 3. Microcentrifuge tube (20 pcs, single use only) | 4. Disposable pestle (20 pcs, single use only) |
| 5. Disposable dropper (20 pcs, single use only) | 6. Instruction manual |

Assay Procedure for WSSV & YHV Rapid Test Kit

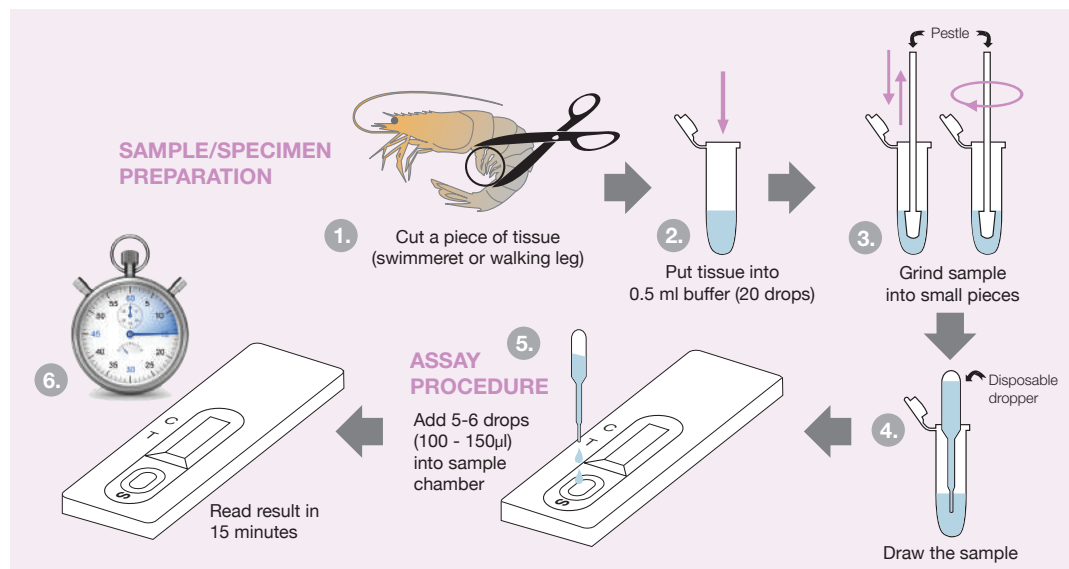

Interpretation of Results

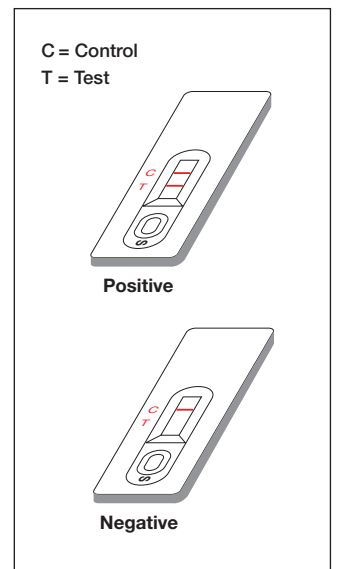

Ordering information:

Product Code	Description	Packing size
RWSS01-020	ShrimpCheck White Spot Syndrome Virus (WSSV) Rapid Test Kit	20 tests/ kit
RYHV01-020	ShrimpCheck Yellow Head Virus (YHV) Rapid Test Kit	20 tests/ kit

Infectious Myonecrosis Virus (IMNV) Rapid Test Kit

Infectious myonecrosis (IMN) is a viral disease of penaeid shrimp caused by myonecrosis virus (IMNV). The genome of IMNV consists of a single, double-stranded RNA molecule of 7560 bp. The principal host species in which IMNV is known to cause significant disease outbreaks and mortalities is *Penaeus vannamei*.

Product description:

ShrimpCheck Infectious Myonecrosis Virus (IMNV) Rapid Test Kit is a management tool based on immunochromatographic assay designed for the qualitative detection of IMNV infection in shrimp.

Kit components:

- | | |
|---|--|
| 1. IMNV rapid test cassette (20 pcs) | 2. Buffer (1 dropper bottle) |
| 3. Microcentrifuge tube (20 pcs, single use only) | 4. Disposable pestle (20 pcs, single use only) |
| 5. Disposable dropper (20 pcs, single use only) | 6. Instruction manual |

Monodon Baculovirus (MBV) Rapid Test Kit

Penaeid shrimps are susceptible to Monodon Baculovirus (MBV) at all stages of life, except eggs and nauplii. MBV has been associated with high mortalities (over 90%) in late postlarvae and juvenile shrimp.

Product description:

ShrimpCheck Monodon Baculovirus (MBV) Rapid Test Kit is a management tool based on immunochromatographic assay designed for the qualitative detection of MBV infection in shrimp.

Kit components:

- | | |
|--|---|
| 1. MBV rapid test cassette (20 pcs) | 2. Buffer I (1 dropper bottles) |
| 3. Buffer II (1 dropper bottle) | 4. Microcentrifuge tube (20 pcs, single use only) |
| 5. Disposable pestle (20 pcs, single use only) | 6. Disposable dropper (20 pcs, single use only) |
| | 7. Instruction manual |

Assay Procedure for IMNV & MBV Rapid Test Kit

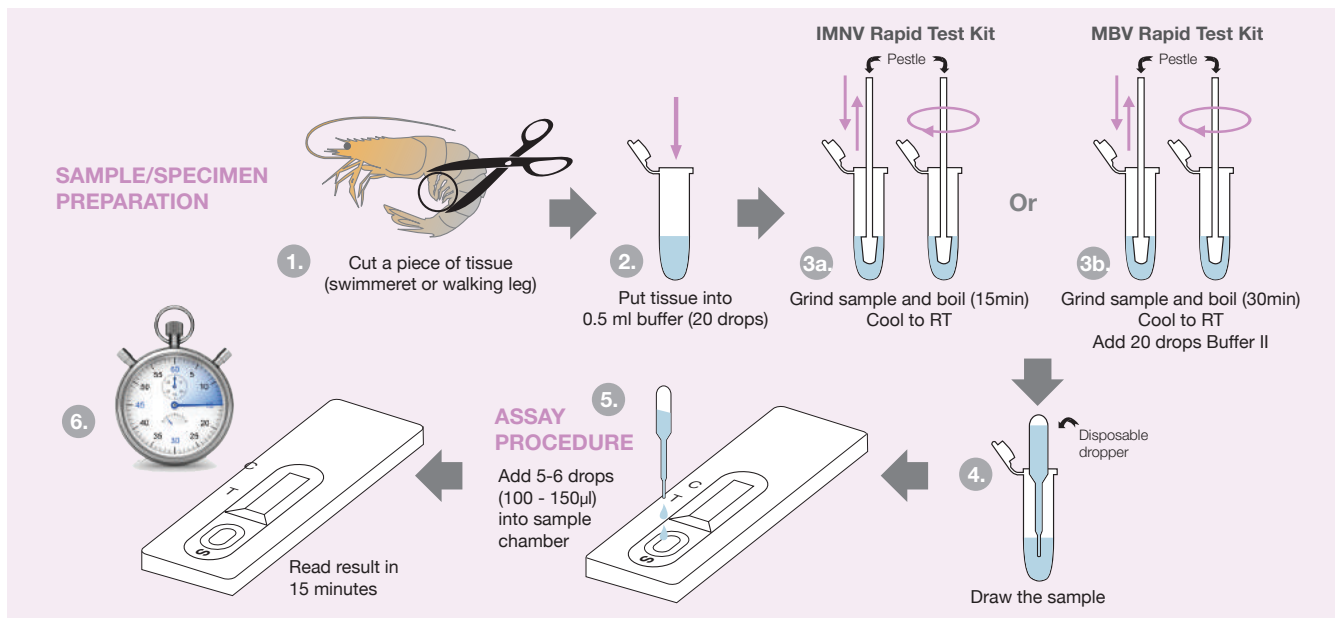

Ordering information:

Product Code	Description	Packing size
RIMN01-020	ShrimpCheck Infectious Myonecrosis Virus (IMNV) Rapid Test Kit	20 tests/ kit
RMBV01-020	ShrimpCheck Monodon Baculovirus (MBV) Rapid Test Kit	20 tests/ kit